

5.

SYSTEM

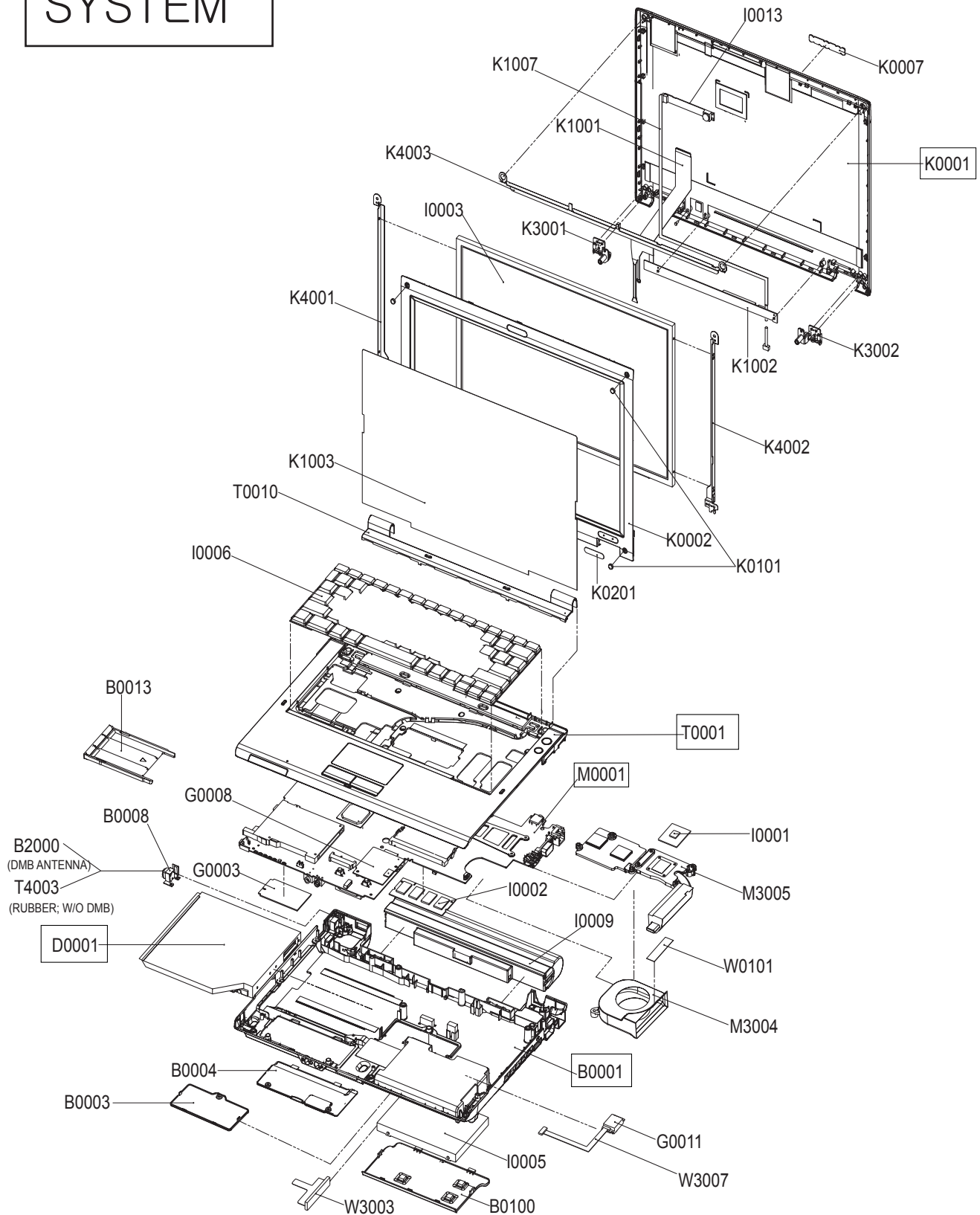

5.

Unit-Housing-Back

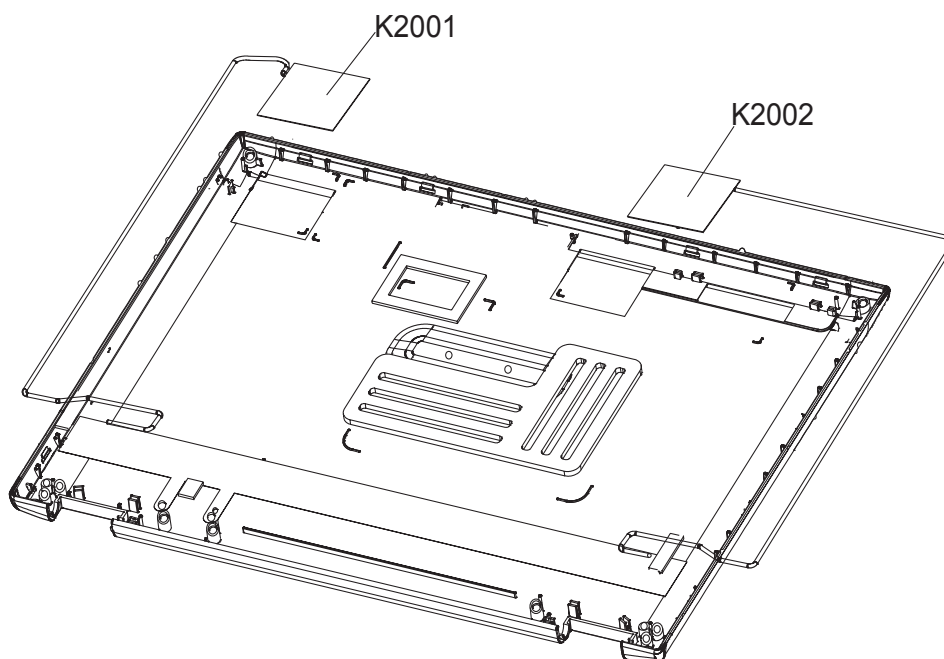
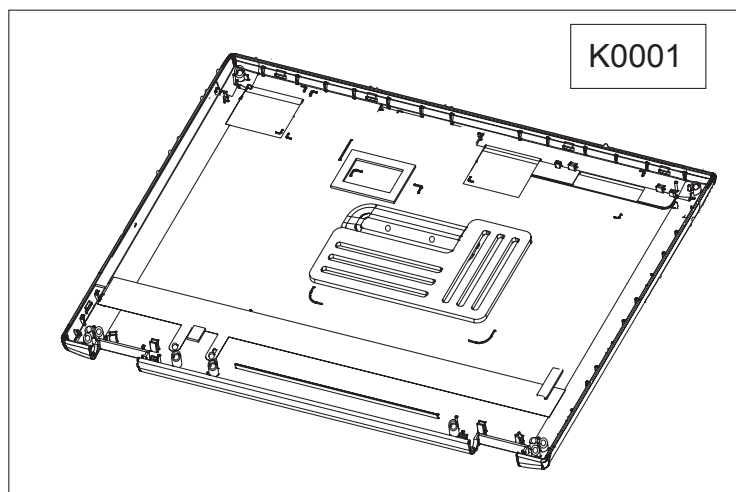

5.

Unit-Housing_Top

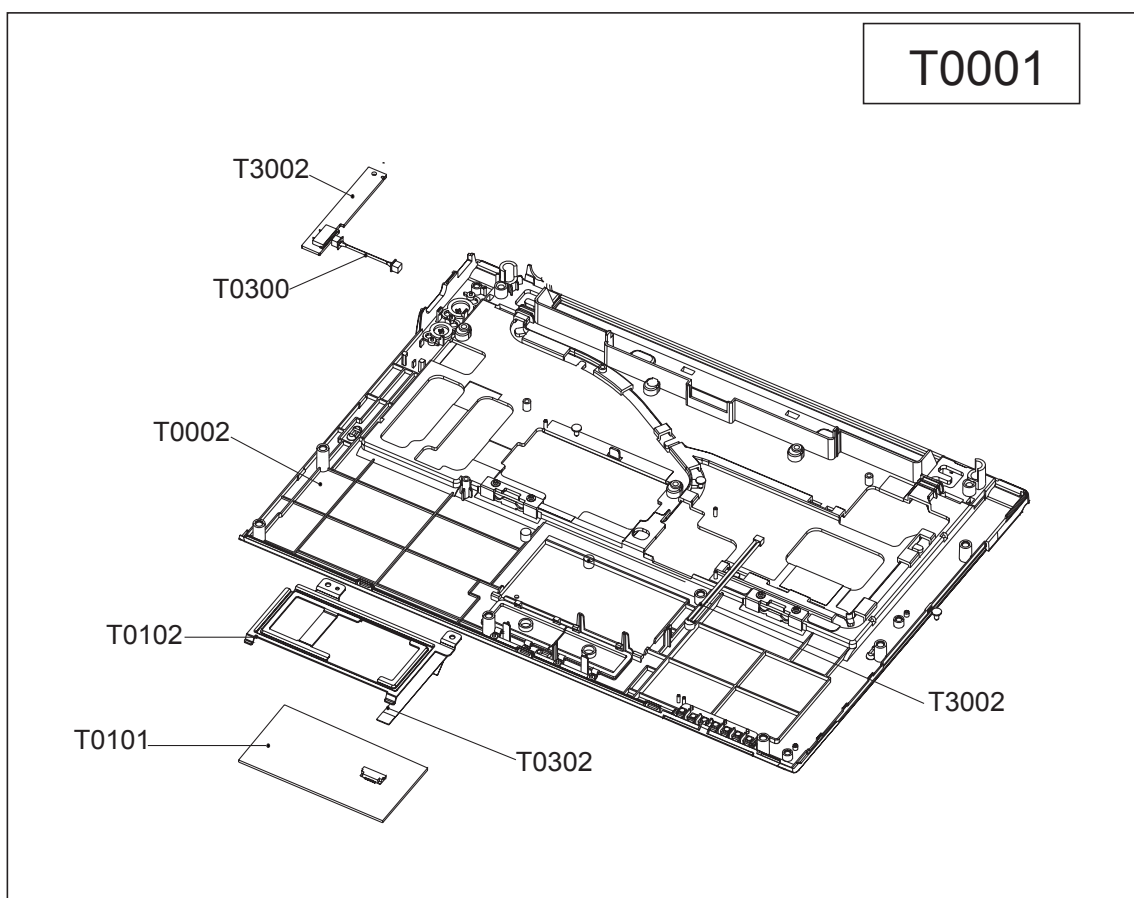

5.

Unit-Housing-Bottom

B0001

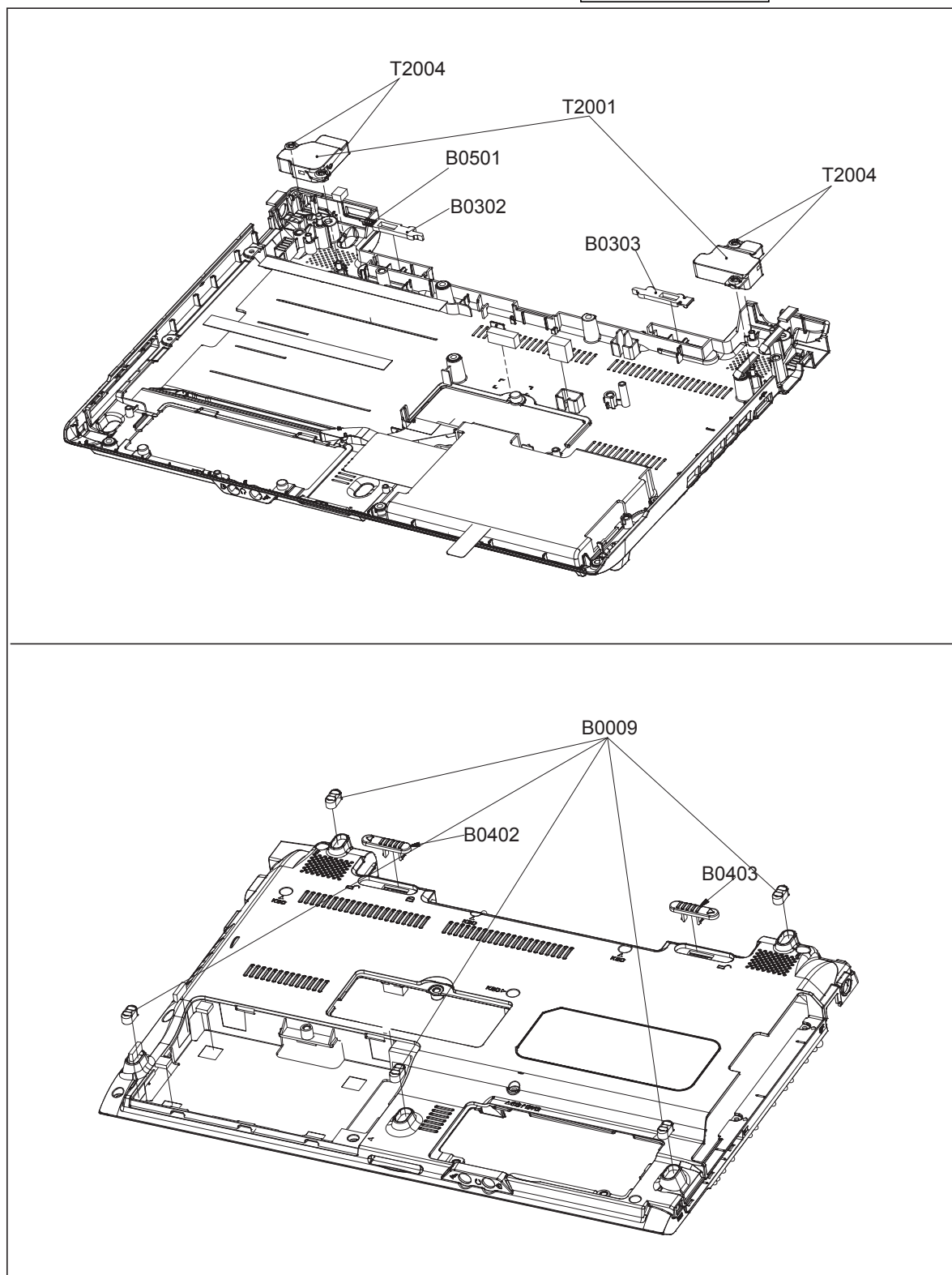

5.

Unit-ODD

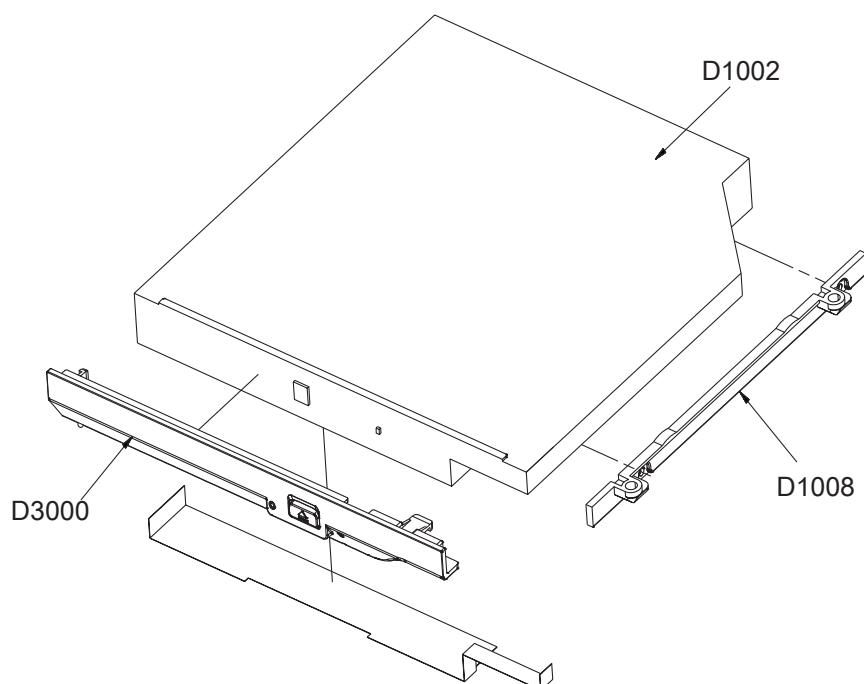
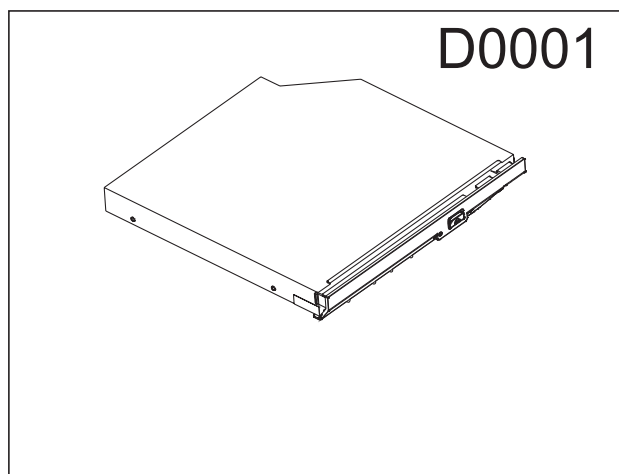

5.

NP-Q45A002/SES

부위코드	자재번호	품 명 및 규 격	수량	서비스성
A0010	3903-000055	CBF-POWER CORD;DT,EU,CP2/NO,E(IEC320 C7)	1	SA
A1001	BA46-05736A	S/W CD;RCD,NP/DT,VISTAB,1.0,SPN,DVD,1/1,	1	SA
A1001	BA46-05803A	S/W CD;UTILITY,TORINO2,WINVISTA,1.0,EXPO	1	SA
B0001	BA75-01887A	UNIT-HOUSING_BOTTOM;TORINO2,-,PC/ABS,W29	1	SA
B0003	BA81-03496A	DOOR-MEMORY;TORINO2,PC/ABS,W75,L39,T1.2M	1	SA
B0004	BA75-01882A	UNIT-DOOR_MINICARD;TORINO2,-,PC/ABS,W60*	1	SA
B0008	BA81-02727A	BRACKET-DMB;TORINO,DOMESTIC,SUS304,T0.5,	1	SA
B0009	BA81-03484A	RUBBER-FOOT;TORINO2,SR,W10.7,L5.3,H5.0MM	5	SA
B0013	BA61-01081A	DUMMY CARD-PCMCIA;FIRENZE2,PC/ABS,T2.4,W	1	SA
B0100	BA75-01884A	UNIT-DOOR_HDD;TORINO2,-,PC/ABS,W137.8*L1	1	SA
B0102	BA73-00238A	RUBBER-HDD_SHOCK;AQUILA,PORON,-,-,-,NTR,	4	SA
B0302	BA81-02690A	LINK-BATT_L;TORINO,DOMESTIC,POM,W31.1*L6	1	SA
B0303	BA81-02691A	LINK-BATT_R;TORINO,DOMESTIC,POM,W26.6*L6	1	SA
B0402	BA81-03500A	KNOB-BATT_L;TORINO2,PC/ABS,W25,L10.3,H6.	1	SA
B0403	BA81-03501A	KNOB-BATT_R;TORINO2,PC/ABS,W25,L10.3,H6.	1	SA
B0501	BA61-00780A	SPRING ETC-BATT;AQUILA-P,STS304,CD0.3,ID	1	SA
D0001	BA96-03084F	ASSY DVD-SUPERMULTI;TORINO2,DVD-Supermul	1	SA
D0001	BA96-03180G	ASSY DVD-SUPERMULTI;TORINO2,DVD-Supermul	1	SA
D0001	BA96-03199E	ASSY DVD-SUPERMULTI;TORINO2,DVD-Supermul	1	SA
D1002	BA59-01900A	DVD-SUPERMULTI;TS-L632D,8x,130ms,EIDE,2M	1	SA
D1002	BA59-01935A	DVD-SUPERMULTI;SSM-8515S,8X,130ms,E-IDE,	1	SA
D1002	BA59-01970A	DVD-SUPERMULTI;UJ-850,8X,180ms,E-IDE,2M,	1	SA
D1008	BA81-02734A	CASE-ODD;TORINO,DOMESTIC,PC/ABS,W115*L8.	1	SA
D3000	BA75-01910A	UNIT-BEZEL_ODD-SUPERMULTI-DL;TORINO2,-,P	1	SA
G0003	BA59-01724A	MODULE-WLAN;Habana,3945ABGMOW2,WMAC+RF,2	1	SA
G0011	BA59-01691A	MODULE-BLUETOOTH;Bluetooth V2.0,T60H928.	1	SA
G0011	BA59-01916A	MODULE-BLUETOOTH;Bluetooth Version 2.0,B	1	SA
I0001	0902-002197	IC-MICROPROCESSOR;LF80537GG0414M,2.0GHz,	1	SA
I0002	1105-001684	IC-DRAM MODULE;M470T2953,DDR2 667MHz,1GB	2	SA
I0003	BA59-01889A	LCD PANEL-12.1WXGA_GLARE;LTN121W1-L03-G,	1	SA
I0005	BA59-01957A	HDD;120G,MHV2120BH-PL,S63,H16,D16385,H9.	1	SA
I0005	BA59-02002A	HDD;120G,HTS541612J9SA00,S63,H16,D16385,	1	SA
I0005	BA59-02039A	HDD;120G,HM120JI,S63,H16,D16385,H9.5mm,2	1	SA
I0006	BA59-02075D	KEYBOARD;Torino2,83Key,-,-,Spain,-,Dark	1	SA

5.

NP-Q45A002/SES

부위코드	자재번호	품 명 및 규 격	수량	서비스성
I0007	BA44-00162A	ADAPTOR;AD-6019(API1AD02),CORONA,-,90TO2	1	SA
I0007	BA44-00238A	ADAPTOR;0335C1960,AD-6019,AC/DC,90to264V	1	SA
I0007	BA44-00243A	ADAPTOR;ADP-60ZH A,AD-6019,AC/DC,90to264	1	SA
I0009	BA43-00156A	BATTERY;3UR18650F-2-SDN-13,Torino,Li-ion	1	SA
I0009	BA43-00168A	BATTERY;P32R06-11-H01,Q35,Li-ION,2P3S,48	1	SA
I0013	BA59-02088A	MODULE-CAMERA;Oslo,SCB-1000S,1.3M CAMERA	1	SA
K0001	BA75-01879F	UNIT-HOUSING_LCD-BACK_R;TORINO2,-,PC/ABS	1	SA
K0002	BA75-01880A	UNIT-HOUSING_LCD-FRONT;TORINO2,-,PC/ABS,	1	SA
K0007	BA64-00700H	LOGO-SAMSUNG;TORINO2,NI,T0.95(W/ TAPE),W	1	SA
K0101	BA81-03753A	RUBBER-FRONT;Torino2,SR,D5*H1.9mm,Black,	4	SA
K0201	BA81-03481A	LABEL-FRT_OVERSEAS;TORINO2,PC(GE LEXAN),	1	SA
K1001	BA39-00617A	CBF COAXIAL CABLE-LCD;TORINO2,BD to COAX	1	SA
K1001	BA39-00628A	CBF COAXIAL CABLE-LCD;torino2,BD to COAX	1	SA
K1002	BA44-00204A	INVERTER;NEON-R,DAC-09N016 AF,DC,8.5to20	1	SA
K1002	BA44-00246A	INVERTER;TORINO_NPC,541180560001,DC,8.5t	1	SA
K1003	BA62-00327A	INSULATION_LCD_PROTECTOR;NEON,PET,T0.1,W	1	SA
K1007	BA39-00630A	CBF HARNESS-CAMERA;torino2,AWG32,-,5P,28	1	SA
K2001	BA42-00182A	ANTENNA-MAIN;SS-03-03-099,Oslo,2.3to6GHz	1	SA
K2002	BA42-00183A	ANTENNA-AUX;SS-03-03-100,Oslo,2.3to6GHz,	1	SA
K3001	BA81-02740A	HINGE-L;TORINO,DOMESTIC,SUS,W26.2*L17.7*	1	SA
K3002	BA81-02744A	HINGE-R;TORINO,DOMESTIC,SUS,W26.2*L17.7*	1	SA
K4001	BA81-03491A	BRACKET_LCD_L;TORINO2,STS304,W10.4,L197.	1	SA
K4002	BA81-03492A	BRACKET_LCD_R;TORINO2,STS304,W10.4,L197.	1	SA
K4003	BA75-01899A	UNIT-BRACKET_LCD-UPPER;TORINO2,-,STS304,	1	SA
L1004	BA68-20039A	LABEL-PPID_E;BLADE,-,PET,-,W50.8,L12.7mm	1	SA
L1005	BA68-20323A	LABEL CAUTION;NOTE PC,-,PET,T0.06,W30.0,	1	SA
M0001	BA92-04515A	ASSY MOTHER BD-TOP;Torino2,Santa Rosa Me	1	SA
M0006	BA39-00431A	WIRE HARNESS;RTC battery assy.,-,UL 1061	1	SA
M1001	BA70-00388A	BRACKET-VGA;FIRENZE,STS304,T0.15mm,-,-,N	1	SA
M1002	3301-001594	BEAD-SMD;90ohm,2.0*1.2*1.3mm,-,TP,-,-,-	1	SA
M1004	2203-001630	C-CER,CHIP;330nF,+80-20%,16V,Y5V,1608	1	SA
M1004	2203-005052	C-CER,CHIP;0.0033nF,0.25pF,50V,NP0,1005	1	SA
M1004	2203-005918	C-CER,CHIP;1000nF,10%,6.3V,X7R,1608	1	SA
M1004	2203-006000	C-CER,CHIP;1NF,10%,3KV,X7R,TP,4520	1	SA

5.

NP-Q45A002/SES

부위코드	자재번호	품 명 및 규 격	수량	서비스성
M1004	2203-006382	C-CER,CHIP;10000nF,10%,25V,X7R,3225	1	SA
M1008	3708-002036	CONNECTOR-FPC/FFC/PIC;20P,0.5mm,SMD-A,AU	1	SA
M1008	3708-002190	CONNECTOR-FPC/FFC/PIC;12,0.5,SMD-A,AUF,Y	1	SA
M1009	3711-004318	HEADER-BOARD TO CABLE;BOX,2P,1R,1.25MM,S	1	SA
M1009	3711-004646	HEADER-BOARD TO BOARD;NOWALL,68P,2R,1.27	1	SA
M1009	3711-005853	HEADER-BOARD TO CABLE;BOX,3p,1R,1.25mm,S	1	SA
M1013	2801-003856	CRYSTAL-SMD;0.032768MHz,20ppm,28-ACP,7pF	1	SA
M1016	0401-000191	DIODE-SWITCHING;MMBD4148,75V,200mA,SOT-2	1	SA
M1018	0505-000110	FET-SILICON;2N7002,N,60V,115mA,7.5ohm,0.	1	SA
M1018	0505-001562	FET-SILICON;SI4816DY,N,30V,5.3/7.7A,30/1	1	SA
M1021	1201-002486	IC-AUDIO AMP;MAX9715ETE+T,TQFN,16P,5x5mm	1	SA
M1024	0801-002195	IC-CMOS LOGIC;7S08,AND GATE,SOT-25,5P,63	1	SA
M1024	0801-002252	IC-CMOS LOGIC;7S14,INVERTER,SOT-25,5P,63	1	SA
M1025	1203-003344	IC-POS.FIXED REG.;MIC5252,SOT-23,5P,2.9	1	SA
M1026	2703-002249	INDUCTOR-SMD;0.5uH,15%,13.0x13.0mm	1	SA
M1026	2703-002280	INDUCTOR-SMD;4.7uH,20%,6965	1	SA
M1028	3722-001732	JACK-IEEE1394;4P/1C,AU30U,-,ANGLE,IEEE13	1	SA
M1028	3722-002002	JACK-USB;4P/1C,TIN,BLK,ANGLE-OFFSET,-	1	SA
M1029	2007-000414	R-CHIP;15ohm,1%,1/10W,TP,1608	1	SA
M1035	3404-001052	SWITCH-TACT;12V,50mA,160gf,5.2x5.2x0.8mm	1	SA
M1036	0504-001157	TR-DIGITAL;DTA114YUA,PNP,200mW,10K/47K,U	1	SA
M1051	0904-002234	IC-MEMORY CONT.;LE88CLGM,FCBGA,1299P,35x	1	SA
M1055	1201-001877	IC-OP AMP;LMV358M,SO,TP,8P,390MIL,DUAL,-	1	SA
M1059	1203-003480	IC-BATTERY;MAX1909,TQFN,28P,5x5mm,PLASTI	1	SA
M1063	0406-001141	DIODE-TVS;PGB1010603NR,-/-/1000V,0W,EIA-	1	SA
M2002	BA61-01074A	BRACKET-SUPPORT_CPU;Torino,SUS,T1.0,W36,	1	SA
M2002	BA61-01075A	BRACKET-SUPPORT_CPU;Torino,SUS,T1.0,W36,	1	SA
M3004	BA31-00045A	FAN;- ,Torino2,Plastic,- ,Leadfree,Delta	1	SA
M3005	BA62-00435A	HEAT SINK-CPU/MCH/GPU;Torino2,Copper;AL,	1	SA
M3005	BA62-00436A	HEAT SINK-CPU/MCH/GPU;Torino2,Copper;AL,	1	SA
M4000	BA59-02036A	MODEM;1456VQL-T3(INT-RoHS),56Kbps,Agere	1	SA
M4000	BA59-02037A	MODEM;T60M951.07 LF,56Kbps,Agere 2 Chip,	1	SA
M4001	BA39-00568A	WIRE HARNESS-MDC;TORINO,WIRE,UL2728,2P/2	1	SA
M4001	BA39-00583A	WIRE HARNESS-MDC;TORINO,WIRE,UL1571,2P/2	1	SA

5.

NP-Q45A002/SES

부위코드	자재번호	품 명 및 규 격	수량	서비스성
M9999	0402-001405	DIODE-SCHOTTKY;B340A,40V,3mA,SMA,TP	1	SA
M9999	0403-001047	DIODE-ZENER;BZX84C12L,5%,225mW,SOT-23,TP	1	SA
M9999	0501-000465	TR-SMALL SIGNAL;MMBT3904,NPN,350mW,SOT-2	1	SA
M9999	0505-001386	FET-SILICON;FDS6680A,N,30V,12.5A,0.0095o	1	SA
M9999	0505-001699	FET-SILICON;FDS8958A,N/P,30/30V,7/-5A,0.	1	SA
M9999	0505-002068	FET-SILICON;SM6K2,N,60V,200mA,4ohm,0.2W,	1	SA
M9999	0601-001130	LED;SMD,RED/GRN,3.0X2.5MM,660/570NM,3.0X	1	SA
M9999	0601-002037	LED;SMD,BLUE,1.6x0.8x0.4mm,465/470nm,1.6	1	SA
M9999	0801-002628	IC-CMOS LOGIC;7SZ08,2-INPUT AND GATE,SC7	1	SA
M9999	0903-001439	IC-MICROCOMPUTER;H8S/2110B,16Bit,TQFP,10	1	SA
M9999	0904-002063	IC-BUS CONTROLLER;R5C843,32Bit,CSP,208P,	1	SA
M9999	0904-002220	IC-I/O CONTROLLER;NH82801HBM,BGA,676P,31	1	SA
M9999	1001-001097	IC-ANALOG SWITCH;FST3125,BUS SWITCH,TSSO	1	SA
M9999	1103-001333	IC-EEPROM;24C08A,1Kx8Bit,SOP,8P,5x4mm,-,	1	SA
M9999	1107-001646	IC-FLASH MEMORY;MX25L8005,8Mbit,8Mx1,SOP	1	SA
M9999	1203-003476	IC-PWM CONTROLLER;ISL6227,SSOP,28P,9.9x3	1	SA
M9999	1203-003765	IC-PWM CONTROLLER;SC486IMLTRT,MLP,24P,4x	1	SA
M9999	1203-003898	IC-POWER SUPERVISOR;SC452IMLTRT,MLP,44P,	1	SA
M9999	1203-004108	IC-PWM CONTROLLER;MAX8734AEEI+T,QSOP,28P	1	SA
M9999	1205-002596	IC-SWITCH;TPS2062,SOIC,8P,5x6x1.65mm,PLA	1	SA
M9999	1205-002806	IC-SWITCH;R5534V-E2-FB,SSOP,20P,6.7x4.4m	1	SA
M9999	1205-002853	IC-CODEC;ALC262-GR,LQFP,48P,7x7mm,PLASTI	1	SA
M9999	1205-003090	IC-ETHERNET CONTROLLER;88E8039,QFN,64P,9	1	SA
M9999	1205-003156	IC-CLOCK GENERATOR;SLG8SP513,QFN,64P,9x9	1	SA
M9999	1209-001718	IC-SENSOR;EMC2102,QFN,28P,5x5mm,PLASTIC,	1	SA
M9999	2007-000309	R-CHIP;10ohm,5%,1/10W,TP,1608	1	SA
M9999	2007-000972	R-CHIP;5.1ohm,5%,1/4W,TP,3216	1	SA
M9999	2007-001341	R-CHIP;680KOHM,5%,1/16W,TP,1005	1	SA
M9999	2007-008789	R-CHIP;0.001ohm,1%,1W,TP,6432	1	SA
M9999	2203-002487	C-CER,CHIP;4.7nF,10%,25V,X7R,1005	1	SA
M9999	2203-006048	C-CER,CHIP;100nF,10%,10V,X7R,1005	1	SA
M9999	2203-006090	C-CER,CHIP;1000nF,10%,6.3V,X5R,2012	1	SA
M9999	2203-006093	C-CER,CHIP;1000nF,+80-20%,6.3V,Y5V,1005	1	SA
M9999	2203-006474	C-CER,CHIP;2200nF,20%,6.3V,X5R,2012	1	SA

5.

NP-Q45A002/SES

부위코드	자재번호	품 명 및 규 격	수량	서비스성
M9999	2402-001120	C-POLYMER AL CHIP;330uF,0.2,6.3V,-,TP,7.	1	SA
M9999	2402-001122	C-POLYMER AL CHIP;100uF,0.2,6.3V,-,TP,7.	1	SA
M9999	3301-000314	BEAD-SMD;120ohm,1.6x0.8x0.8mm,-,-,-	1	SA
M9999	3301-001772	BEAD-SMD;27ohm,1608,-,TP,30ohm/120MHz,48	1	SA
M9999	3404-001311	SWITCH-TACT;12VDC,50mA,100gf,6.0x6.0x5.0	1	SA
M9999	3701-001403	CONNECTOR-DSUB;15P,2R,FEMALE,ANGLE,NI	1	SA
M9999	3704-001153	SOCKET-IC;479P,PGA,AU,1.27mm	1	SA
M9999	3709-001325	CONNECTOR-CARD EDGE;200P,0.6mm,SMD-A,AU,	1	SA
M9999	3709-001375	CONNECTOR-CARD EDGE;200P,0.6mm,SMD,AUF,S	1	SA
M9999	3709-001401	CONNECTOR-CARD EDGE;52P,0.8mm,SMD-A,AU,m	1	SA
M9999	3709-001413	CONNECTOR-CARD EDGE;44P,0.8mm,SMD-A,AU,4	1	SA
M9999	3709-001425	CONNECTOR-CARD EDGE;-,-,-,Ni,PCMCIA Fram	1	SA
M9999	3710-002130	SOCKET-BOARD TO CABLE;30P,1R,0.5mm,SMD-S	1	SA
M9999	3710-002133	SOCKET-BOARD TO BOARD;12P,2R,0.8mm,SMD-A	1	SA
M9999	3710-002314	SOCKET-BOARD TO BOARD;50P,2R,0.8mm,ANGLE	1	SA
M9999	3711-000541	HEADER-BOARD TO CABLE;BOX,2P,1R,1.25mm,S	1	SA
M9999	3711-002050	CONNECTOR-HEADER;BOX,10P,1R,1.25mm,SMD-A	1	SA
M9999	3711-004779	CONNECTOR-HEADER;BOX,6P,1R,1.25mm,SMD-A,	1	SA
M9999	3711-005854	HEADER-BOARD TO CABLE;BOX,4P,1R,1.25mm,S	1	SA
M9999	3711-005947	HEADER-BOARD TO BOARD;BOX,8P,1R,1MM,SMD-	1	SA
M9999	3711-006058	HEADER-BATTERY;NOWALL,5P,1R,2.5mm,DIP,AU	1	SA
M9999	3719-001350	CONNECTOR-ACCESSORY;- ,FEMALE,P-BRONZE,Sn	1	SA
M9999	3722-002191	JACK-DC POWER;3P,5.6pi,Sn-P,Black	1	SA
M9999	3722-002246	JACK-MODULAR;2P,REVERSE,NO,SMT-A,NO,BLK,	1	SA
M9999	3722-002390	JACK-MODULAR;8P/8C,REVERSE,YES,ANGLE-OFF	1	SA
M9999	3722-002545	JACK-PHONE;6P,AU,PINK,ANGLE	1	SA
M9999	3722-002548	JACK-PHONE;5P,AU,BLK,ANGLE	1	SA
M9999	BA61-00963A	SUPPORT-VIDEO_BOARD-LF;VENICE,CU ALLOY,T	1	SA
M9999	BA62-00389A	INSULATION-MEMORY;SEDONA,PC,T0.2,W64,L30	2	SA
M9999	BA81-02808A	INSULATOR-PCMCIA;FIRENZE2,PC,W72*L50*T0.	1	SA
M9999	BA81-03483A	INSULATOR-ODD;TORINO2,PC,W12.5,L12,T0.2M	1	SA
M9999	BA81-03488A	INSULATOR-DVBT;OSLO,PC,T0.1,W47*L30mm,BL	1	SA
M9999	BA81-03719A	INSULATOR-MICOM;TORINO2,PC,W50.0*L35.0*T	1	SA
RUB01	BA81-03728A	RUBBER-SUPPORT_TOUCHPAD;TORINO2,SBR,W8.0	1	SA

5.

NP-Q45A002/SES

부위코드	자재번호	품 명 및 규 격	수량	서비스성
T0001	BA75-01878A	UNIT-HOUSING_TOP;TORINO2,-,PC/ABS,W295.2	1	SA
T0002	BA75-01926A	UNIT-HOUSING_TOP-SVC;TORINO2,PC/ABS,W295	1	SA
T0005	BA68-03686A	LABEL-LOGO_VISTA-PREMIUM;N/P ALL,VISTA P	1	SA
T0005	BA68-03850C	LABEL-ZAIGEN;Torino2,ENG _EECIS,PET,-,W4	1	SA
T0005	BA68-03880A	LABEL-LOGO_CENTRINO-DUO2_SANTA;OSLO,N/P	1	SA
T0010	BA75-01890A	UNIT-CAP_TOP;TORINO2,-,PC/ABS,W261*L24.3	1	SA
T0101	BA59-01801A	BOARD-TOUCHPAD;Hainan,TM-00379-003,BONGW	1	SA
T0102	BA81-03494A	BRACKET-TOUCHPAD;TORINO2,STS304,W71.4,L8	1	SA
T0300	BA39-00569A	WIRE HARNESS-ONTOP;TORINO,WIRE,UL1571,6P	1	SA
T0300	BA39-00577A	WIRE HARNESS-ONTOP;TORINO,WIRE,UL10064,6	1	SA
T0302	BA41-00661A	FFC-TOUCHPAD;TORINO,1.0,Film,12Pin,T0.01	1	SA
T2001	BA96-03225A	ASSY SPEAKER;TORINO2,X03030R-004,80*195m	1	SA
T2200	BA39-00524A	CBF HARNESS-MIC;HABANA,-,AWG32,2P,-,Writ	1	SA
T3002	BA92-04513A	ASSY ETC;TORINO2,ONTOP BOARD	0.001	SA
T4003	BA81-02760A	RUBBER-DMB;TORINO,DOMESTIC,SILICON RUBBE	1	SA
W0101	BA81-03720A	GASKET-FAN;TORINO2,PU SPONGE,W40.0*L10.0	1	SA
W3003	BA41-00725A	FPC-SATA_HDD;torino2,1.0,POLYAMIDE,20P,0	1	SA
W3007	BA39-00619A	CBF HARNESS-BLUETOOTH;torino2,WIRE,UL100	1	SA
W4001	6001-001650	SCREW-MACHINE;BH,+,-,M2,L3,NI PLT,SWRCH1	2	SA
W4001	6001-001651	SCREW-MACHINE;BH,+,-,M2,L6,NI PLT,SWRCH1	4	SA
W4002	6001-000730	SCREW-MACHINE;CH,+,-,M2,L7,ZPC(BLK),SWRC	10	SA
W4002	6001-001406	SCREW-MACHINE;CH,+,-,M2.0,L6.0,NI PLT,SWRC	2	SA
W4002	6001-001413	SCREW-MACHINE;CH,+,-,M2,L5,NI PLT,SWRCH1	4	SA
W4002	6001-001420	SCREW-INCH MACH;CH,+,-,UNC4-40,L4,NI PLT,S	2	SA
W4002	6001-001549	SCREW-MACHINE;CH,+,-,M3,L5,ZPC(BLK),SWRCH1	2	SA
W4002	6001-001570	SCREW-MACHINE;CH,+,-,M2,L4,ZPC(BLK),SWRC	1	SA
Z8999	2603-000048	TRANS-MATCHING;- ,1:1,0mA,6P:6P,11.81x8.6	1	SA