

3. Exploded View and Parts List

3-1. Exploded View

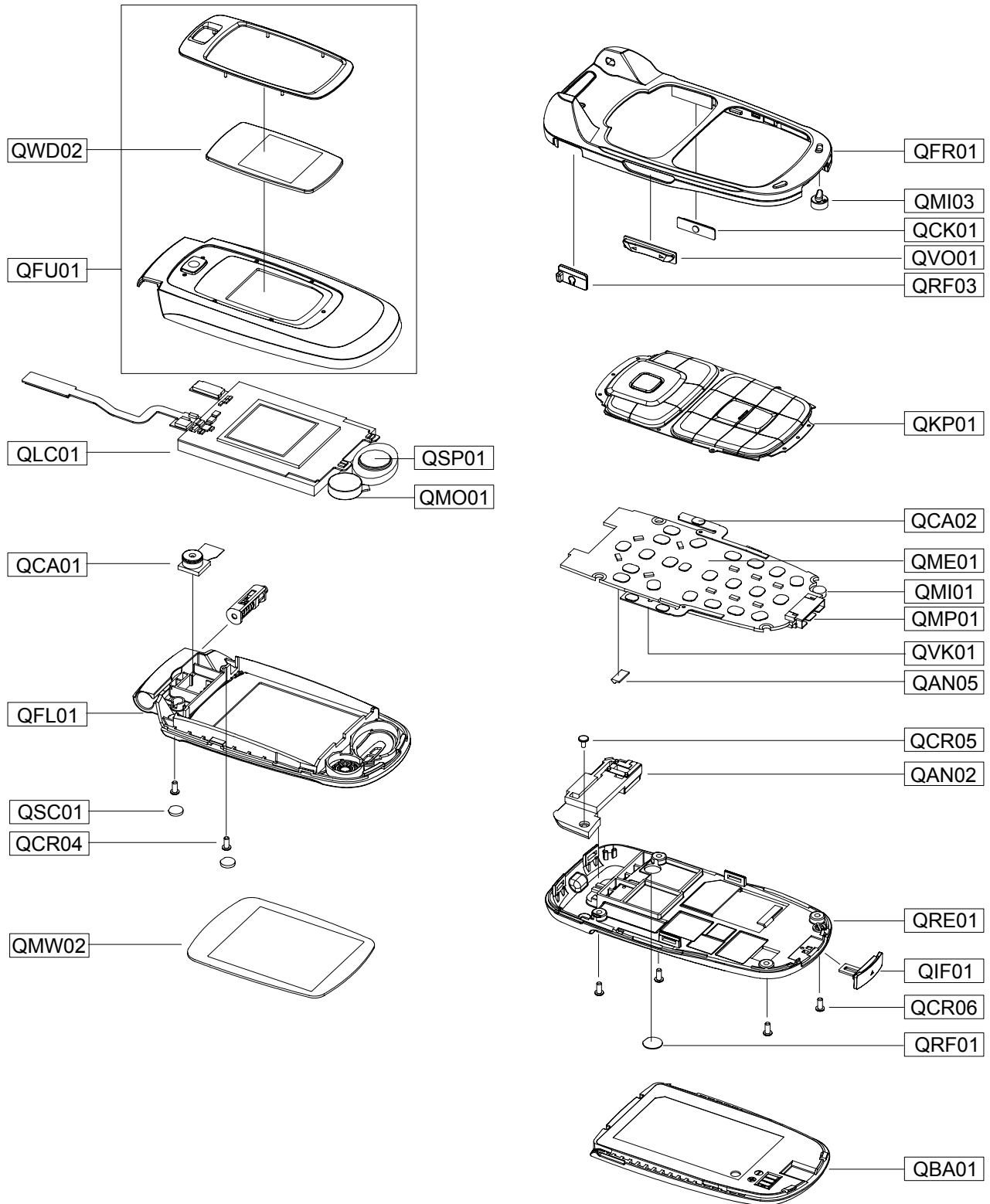

3-2. Parts List

Location NO.		SEC CODE	Description
QSP01		SPEAKER	3001-001912
QCR06		SCREW-MACHINE	6001-001155
QCR05		SCREW-MACHINE	6001-001478
QCR04		SCREW-MACHINE	6001-001479
QMI01		MICROPHONE-ASSY-SGHX670	GH30-00248A
QMO01		MOTOR DC-SGHX670	GH31-00154E
QAN02		ANTENNA-SGHX670	GH42-00753A
QBA01		BATTERY-800MAH,SIL,ENG,M	GH43-02348A
QME01		UNIT-METAL DOME	GH59-02873A
QVK01		UNIT-VOLUME KEY	GH59-02874A
QCA02		UNIT-CAMERA KEY	GH59-02875A
QCA01		UNIT-CAMERA	GH59-02876A
QRF03		PMO-COVER EAR	GH72-27157A
QIF01		PMO-COVER IF	GH72-27165A
QWD02		PCT-WINDOW SUB	GH72-27169A
QMW02		PCT-WINDOW MAIN	GH72-27171A
QRF01		MPR-SHEET RF	GH74-21697A
QAN05		MEC-ANTENNA CONTACT	GH75-08168A
QFU01		MEC-CASE UPPER FOLDER	GH75-08684A
QFL01		MEC-CASE LOWER FOLDER	GH75-08685A
QRE01		MEC-CASE REAR	GH75-08687A
QKP01		MEC-KEYPAD(XEF/SIL)	GH75-09270A
QSC01		MEC-SCREW CAP	GH75-09586A
QMP01		PBA MAIN-SGHX670	GH92-02512A
QLC01		MEA-LCD MODULE KIT(X670)	GH97-05644A
QFR01		MEC-CASE FRONT	GH75-08686A
	QCK01	PMO-CAMERA KEY	GH72-27155A
	QMI03	RMO-MIC HOLDER	GH73-06436A
	QVO01	PMO-VOLUME KEY	GH72-27156A

SEC CODE	Description
BAG PE	6902-000634
ADAPTOR-TAD	GH44-00482A
UNIT-EARPHONE(SIL)	GH59-02472B
SPRING ETC-BATT LOCKER	GH61-00120A
LABEL(P)-IMEI	GH68-01335D
LABEL(P)-WATER SOAK	GH68-02026A
LABEL(R)-MAIN(EU)	GH68-09241A
MANUAL USERS-EU ITALIAN	GH68-09437A
CUSHION-CASE(1~2)	GH69-03629A
BOX(P)-SGHX670(EU)	GH69-03630A
MPR-BOHO VINYL LCD CONN	GH74-15350A
MPR-SHEET FILTER LCD FPCB	GH74-21694A
MPR-VINYL BOHO UPPER	GH74-21700A
MPR-VINYL BOHO MAIN LCD	GH74-21701A
MPR-VINYL BOHO LOWER	GH74-21702A
MPR-CUSHION LCD	GH74-22342A
MPR-TAPE FOAM CAMERA	GH74-22344A
MPR-TAPE INSULATION CAM CONN	GH74-22611A
MPR-GASKET UPPER	GH74-22612A
MPR-TAPE CONDUCTION DOME SHEET	GH74-22613A
MPR-TAPE INSULATION HALL IC	GH74-22614A
MPR-TAPE INSULATION J TAG	GH74-22615A
MPR-VINYL BOHO SUB	GH74-22719A
MEC-HANGER	GH75-03673B

3-3. Test Jig (GH80-03306A)

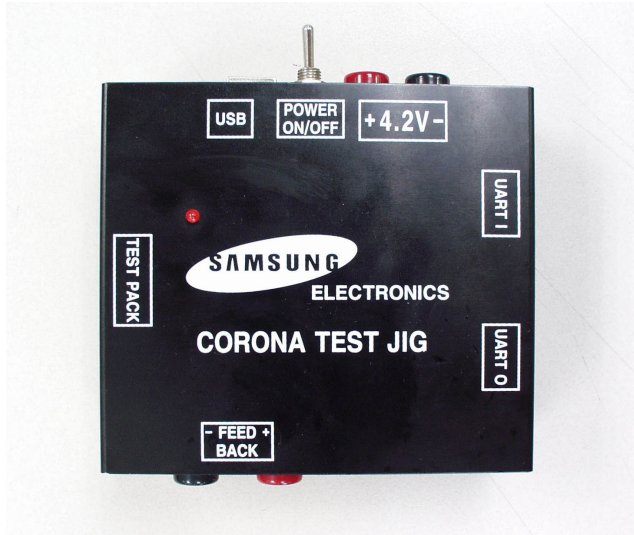

3-3-1. USB JIG Cable

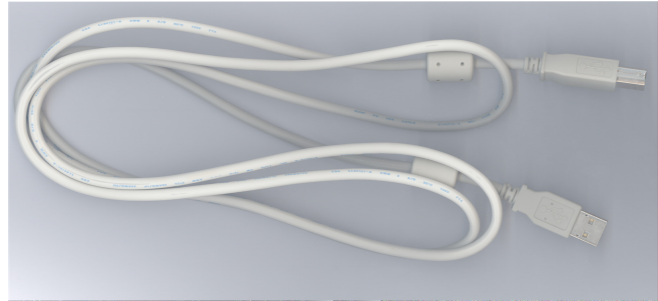

3-3-2. RF Test Cable
(GH39-00283A)



3-3-3. Test Cable
(GH39-00337A)



3-3-4. Serial Cable
(CSA LL64151-A)

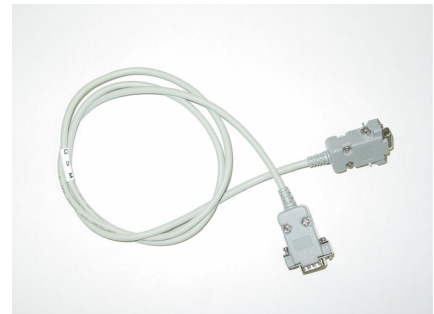

3-3-5. Power Supply Cable

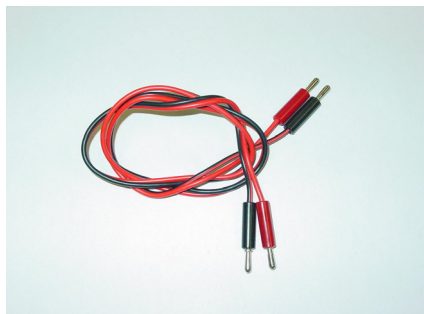

3-3-6. DATA CABLE
(GH39-00331A]



3-3-7. TA
(GH44-00482A)

