

5. Exploded View and Parts List

5-1. Cellular phone Exploded View

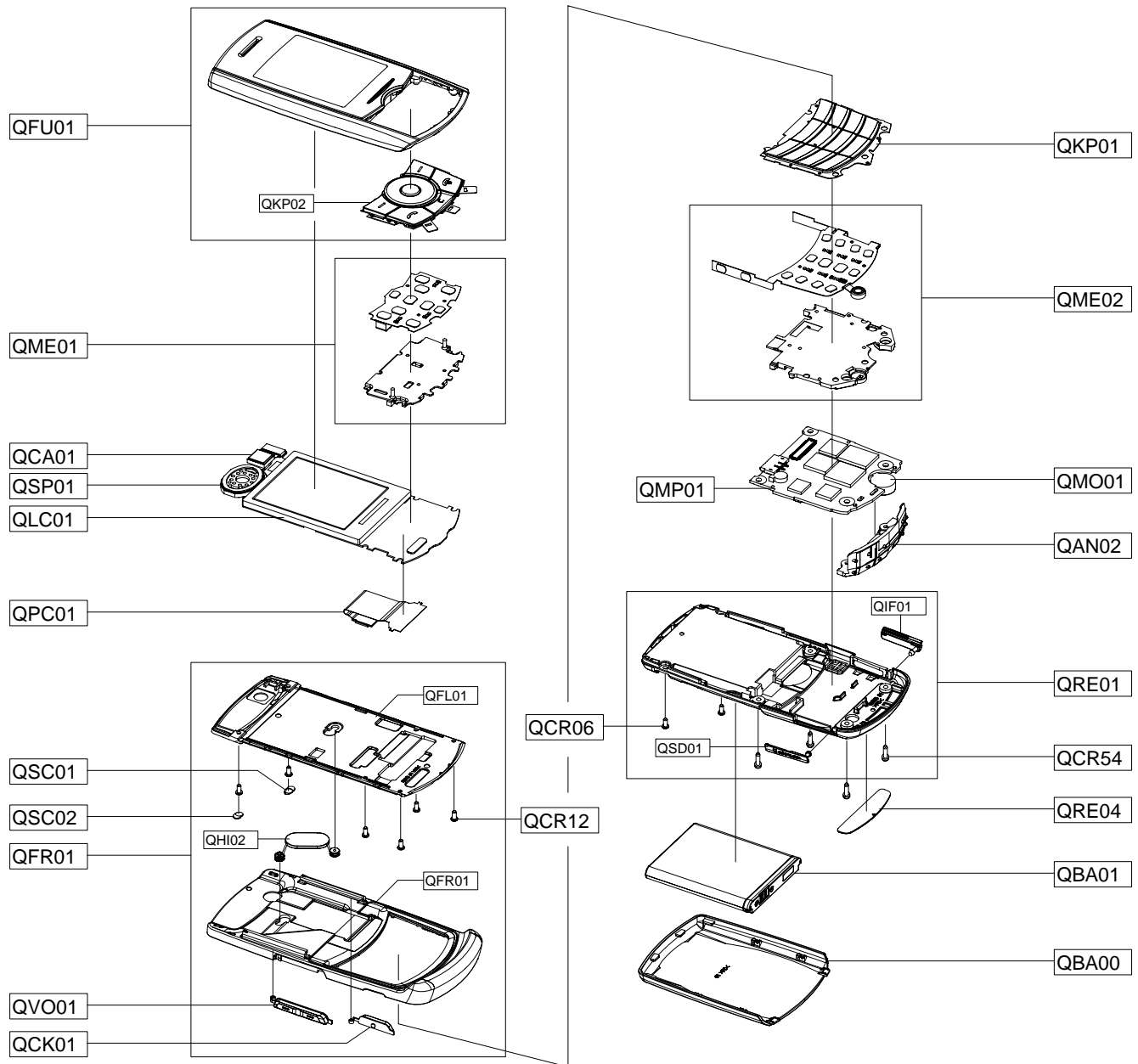

5-2. Cellular phone Parts list

Design LOC	Description	SEC CODE
QAN02	ANTENNA-SGH_J610	GH42-01260A
QBA00	PMO COVER-BATTERY	GH72-41831D
QBA01	INNER BATTERY PACK-800MAH,BLK,	GH43-02719A
QCA01	CAMERA MODULE	GH59-04663A
QCK01	PMO KEY-CAMERA	GH72-41828D
QCR06	SCREW-MACHINE	6001-001155
QCR12	SCREW-MACHINE	6001-001530
QCR54	SCREW-MACHINE	6001-001645
QFL01	ASSY CASE-SLIDE LOWER	GH98-04846D
QFR01	ASSY CASE-FRONT	GH98-04847D
QFR02	ASSY CASE-SLIDE FRONT	GH98-07325D
QFU01	ASSY CASE-SLIDE UPPER	GH98-04845D
QHI02	ASSY HINGE-SLIDE	GH98-05660A
QIF01	PMO COVER-IF	GH72-41830D
QKP01	ASSY KEYPAD-MAIN(SER/MAA)	GH98-06066D
QKP02	ASSY KEYPAD-SUB(XEF/MAA)	GH98-04852D
QLC01	ELA UNIT-SGH_J610 LCD MODULE	GH96-02655A
QME01	KEY FPCB-MAIN KEY FPCB	GH59-04593A
QME02	KEY FPCB-MAIN 3X4 KEY FPCB	GH59-04594A
QMO01	MOTOR DC-SGH_J610	GH31-00343A
QMP01	PBA MAIN-SGHJ610	GH92-03699A
QPC01	MEA-SLIDE FPCB KIT	GH97-08402A
QRE01	ASSY CASE-REAR	GH98-04848D
QRE04	PMO DECO-REAR	GH72-41832D
QSC01	PMO COVER-SCREW L	GH72-44802D
QSC02	PMO COVER-SCREW R	GH72-44803D
QSD01	PMO COVER-SD	GH72-41829D
QSP01	SPEAKER	3001-002176
QVO01	PMO KEY-VOLUME	GH72-41827D

Description	SEC CODE
ADAPTOR-ATADS10EBE,BLK,EU	GH44-01702A
EARPHONE-SGHE210,AAEP405MBE,A	GH59-04535A
RMO-DAMPER SLIDE UPPER	GH73-09804A
TAPE-UPPER DAMPER	GH74-32954A
TAPE INSU-CAMERA CONN	GH74-33083A
TAPE INSU-SLIDE CONN	GH74-33084A
TAPE-FPCB CONN	GH74-34139A
TAPE-SHIELD	GH74-34597A
MPR-REMOVE TAPE LCD	GH74-13804A
MPR-TAPE LED	GH74-17926A
MPR-TAPE	GH74-27509A
MPR-INSU TAPE	GH74-27512A
LABEL(R)-WATER SOAK	GH68-09361A
MANUAL USERS-EU RUSSIAN	GH68-16414A
MANUAL USERS-EU ENGLISH	GH68-16419A
S/W CD-SGH_J6100 PC LINK CD	GH46-00586A
BAG PE	6902-000634
LABEL(P)-UNIT SEAL	GH68-00518B
LABEL(R)-MAIN(EU)	GH68-16522A
BOX(P)-UNIT MAIN(EU)	GH69-06102A
CUSHION-CASE(EU)	GH69-06103A
CBF INTERFACE-DLC APCBS10BBE(S	GH39-00922A