

5. Exploded View and Parts List

5-1. Cellular phone Exploded View

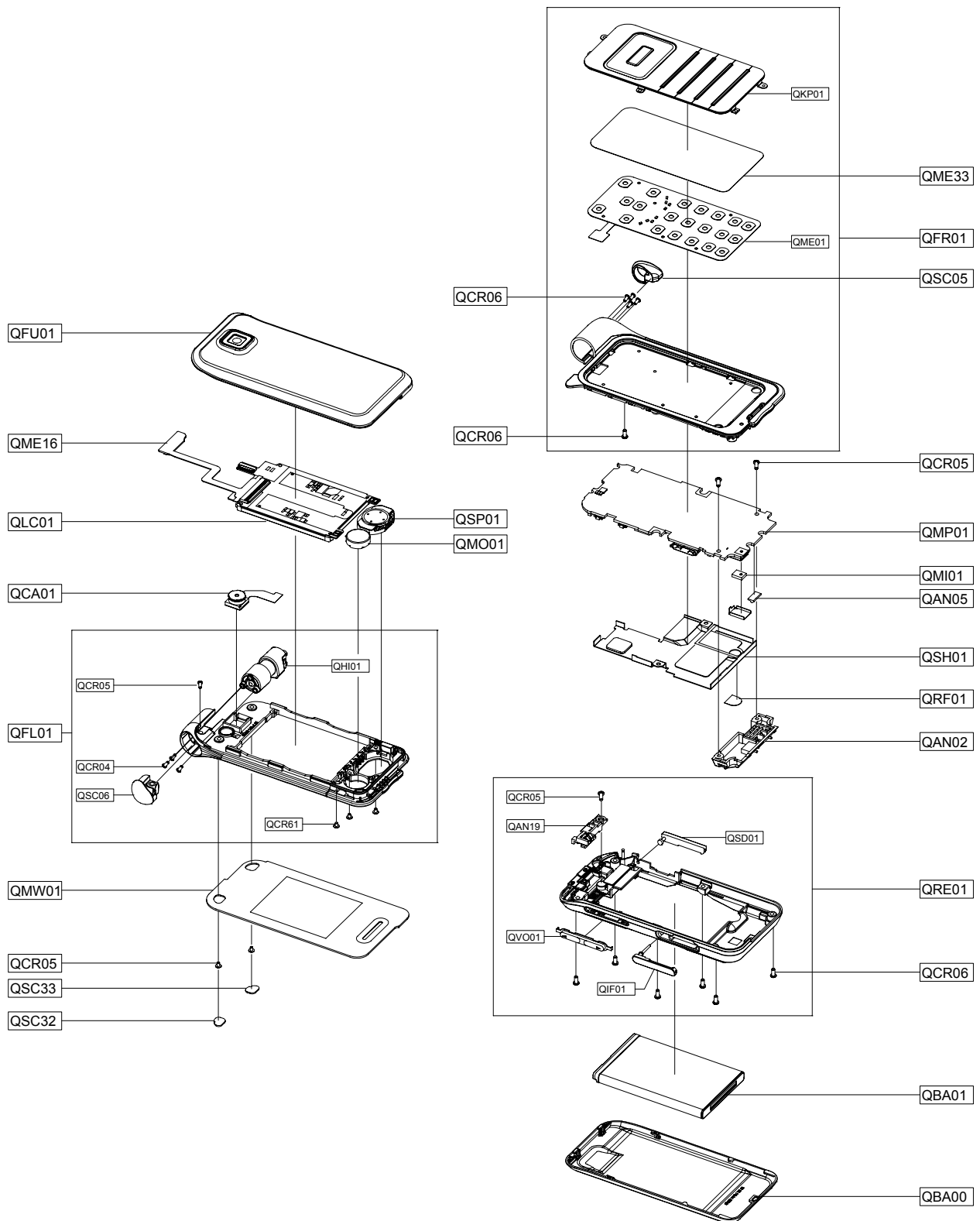

5-2. Cellular phone Parts List

Design LOC		Description	SEC CODE
QAN02		INTENNA-SGHL310	GH42-01464A
QAN05		ASSY MEC-INTENNA CONTACT	GH75-08168A
QBA00		ASSY COVER-BATT	GH98-07029A
QBA01		INNER BATTERY PACK-800MAH,BLK,	GH43-03039A
QCA01		CAMERA MODULE-2M 1/4"	GH59-05186A
QCR05		SCREW-MACHINE	6001-001478
QCR05		SCREW-MACHINE	6001-001478
QCR06		SCREW-MACHINE	6001-001155
QCR06		SCREW-MACHINE	6001-001155
QFL01		ASSY CASE-LOWER	GH98-06825A
QFR01		ASSY CASE-FRONT(SER)	GH98-07310A
QFU01		ASSY CASE-UPPER	GH98-06819A
QLC01		LCD-SGHL310 1.8"	GH07-01226A
QME16		UNIT-CON TO CON	GH59-05284A
QME33		KEY FPCB-DOPARO FPC ASS'Y	GH59-05502A
QMI01		MICROPHONE-ASSY-SGHL310 SMD TY	GH30-00457A
QMO01		MOTOR DC-SGH-L310	GH31-00403A
QMP01		PBA MAIN-SGHL310	GH92-04339A
QMW01		ASSY COVER-WINDOW MAIN(RUS)	GH98-07971A
QRE01		ASSY CASE-REAR	GH98-06820A
QRF01		TAPE-RF 2	GH74-37481A
QSC05		PMO COVER-RIGHT SCREW CAP V2	GH72-45164A
QSC32		ASSY COVER-WINDOW LEFT SCREW C	GH98-07991A
QSC33		ASSY COVER-WINDOW RIGHT SCREW	GH98-07992A
QSH01		ASSY BRACKET-PBA SHIELD CAN	GH98-06828A
QSP01		MICRO SPEAKER	3001-002296

Design LOC		Description	SEC CODE
	QAN19	INTENNA-SGHL310BT	GH42-01507A
	QCR04	SCREW-MACHINE	6001-001479
	QCR05	SCREW-MACHINE	6001-001478
	QCR05	SCREW-MACHINE	6001-001478
	QCR61	SCREW-MACHINE	6001-002008
	QHI01	ASSY HINGE-LCD	GH98-06822A
	QIF01	PMO COVER-IF	GH72-44707A
	QKP01	ASSY KEYPAD-(SER/BLK)	GH98-07136A
	QME01	KEY FPCB-SGH-L310 22KEY	GH59-05289A
	QSC06	PMO COVER-LEFT SCREW CAP V2	GH72-45163A
	QSD01	PMO COVER-SD	GH72-44708A
	QVO01	PMO KEY-VOLUME	GH72-44709A

